



**INSTRUCTIONS DE MONTAGE  
ASSEMBLY INSTRUCTIONS**



**tsume**

**HQS BY TSUME**



**NE MONTEZ PAS VOTRE STATUE DE COLLECTION IMMÉDIATEMENT APRÈS L'AVOIR REÇUE.**

**Laissez le temps à la résine de se réchauffer à température ambiante pendant 24 heures afin d'éviter tout risque de casse.**

**PLEASE DO NOT ASSEMBLE YOUR STATUE RIGHT AFTER YOU HAVE RECEIVED IT.**

**The resin material needs time to warm up at room temperature a daytime to avoid risks of breaking.**



**DE PRÉFÉRENCE, METTEZ DES GANTS EN LATEX POUR MANIPULER VOTRE STATUE.**

**WE RECOMMEND TO PUT LATEX GLOVES ON TO HANDLE YOUR STATUE.**



**1** Placez le premier tuyau brisé sur le socle.  
Place the first broken pipe on the base.

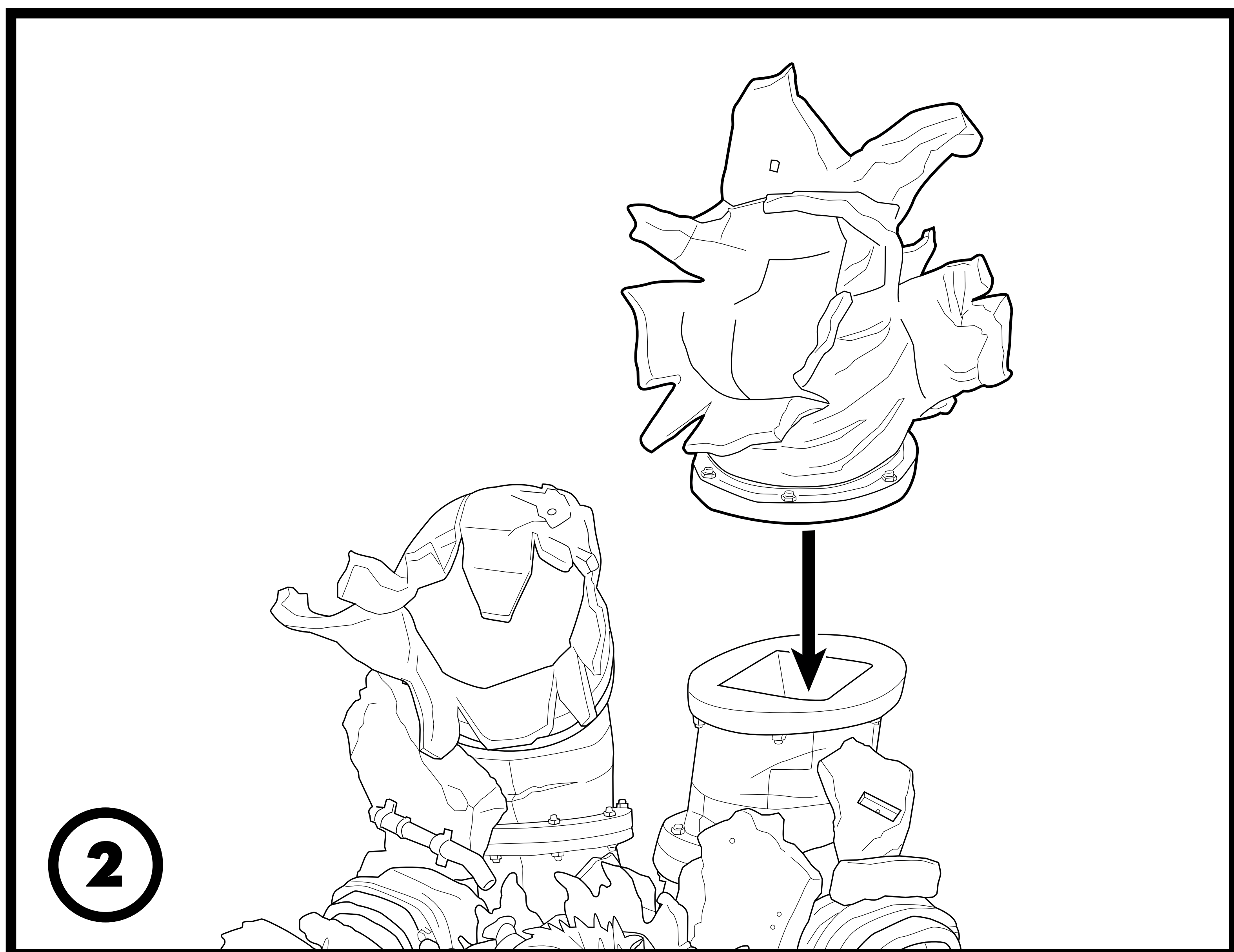

**2** Placez le second tuyau brisé sur le socle.  
Place the second broken pipe on the base.

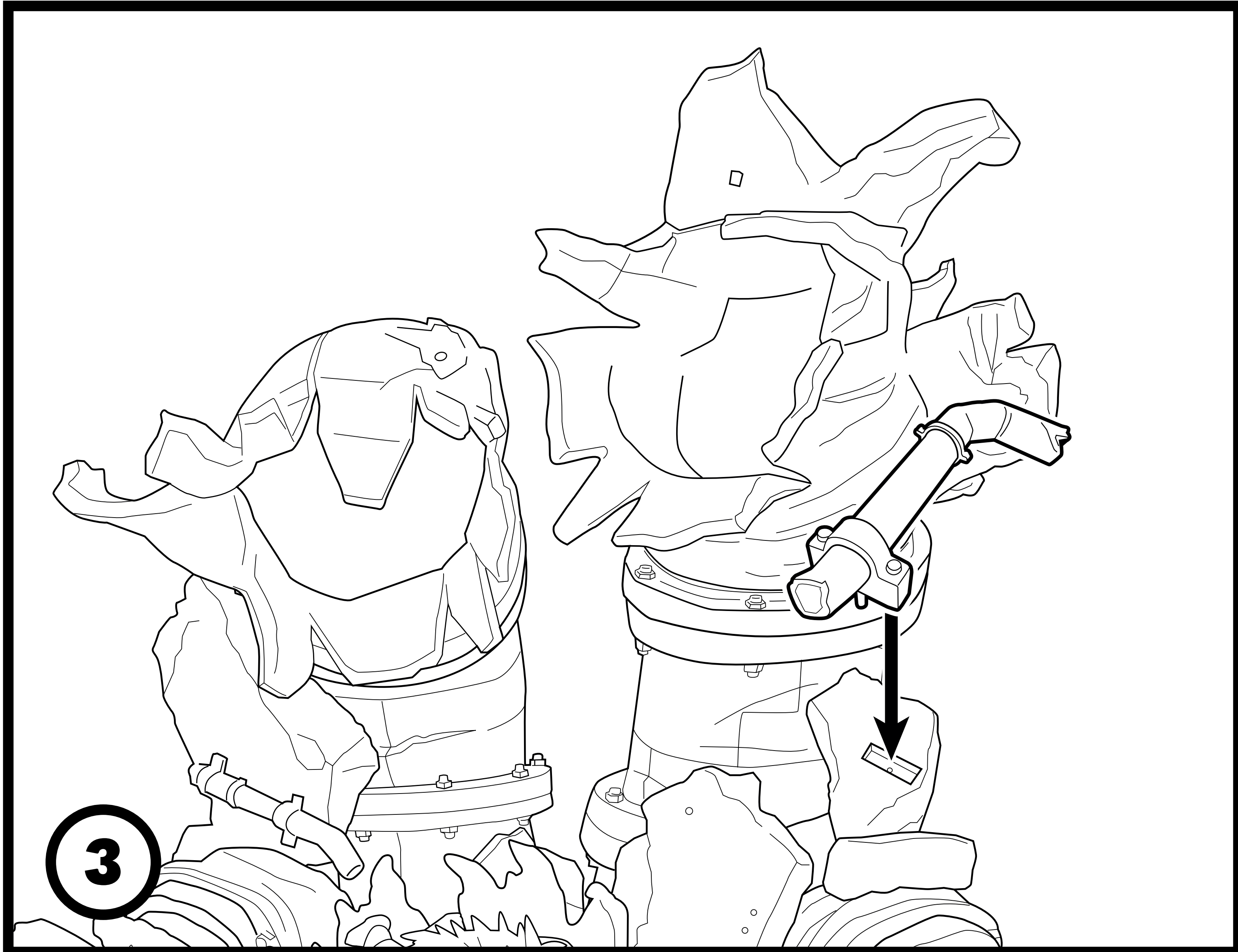

- 3** Placez le premier petit tuyau sur une des pierres.  
Place the first small pipe on one of the stones

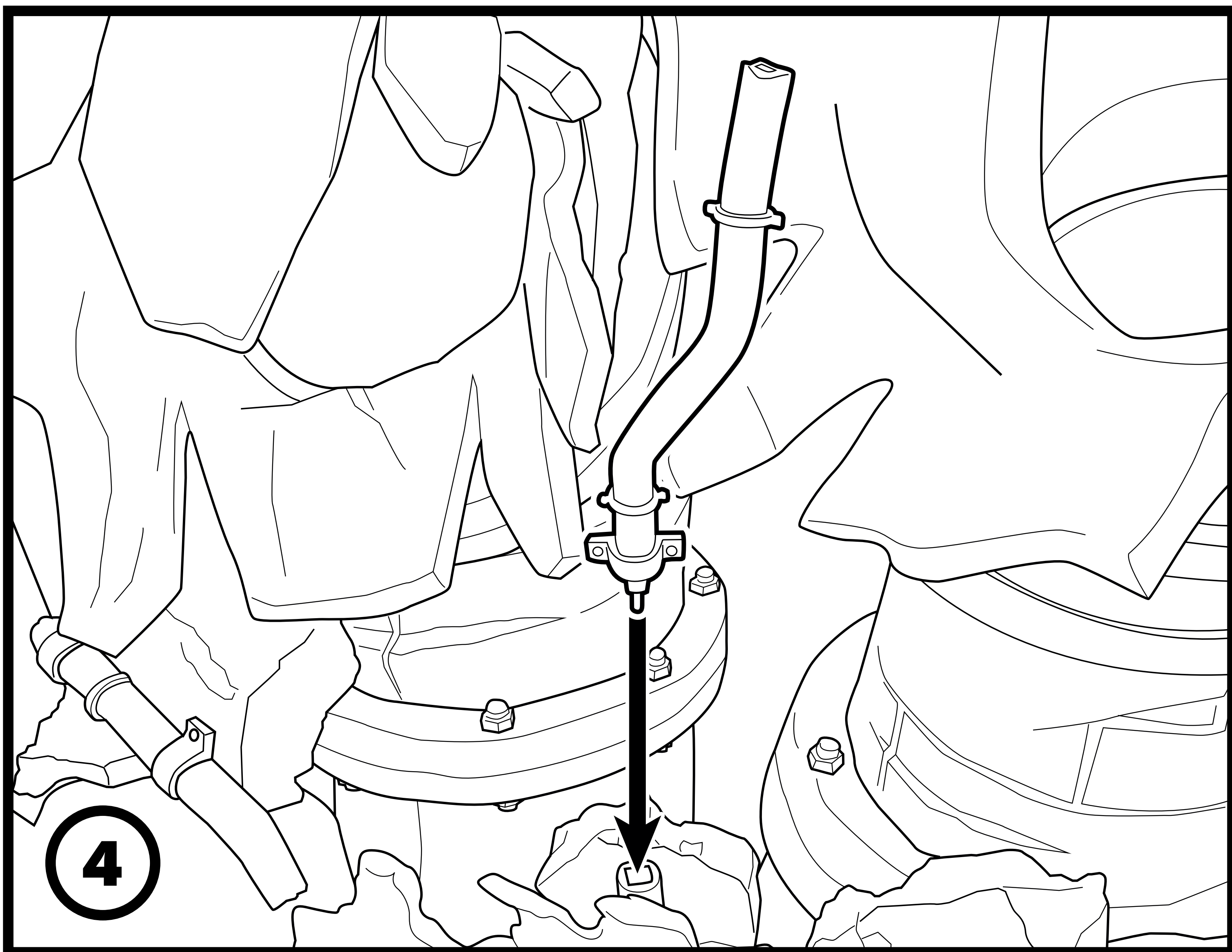

- 4** Insérez le second petit tuyau dans le socle.  
Insert the second small pipe into the base.



**5** Insérez le genou du premier Pain dans la vague à gauche du socle.  
Insert the first Pain's knee into the wave on the left.

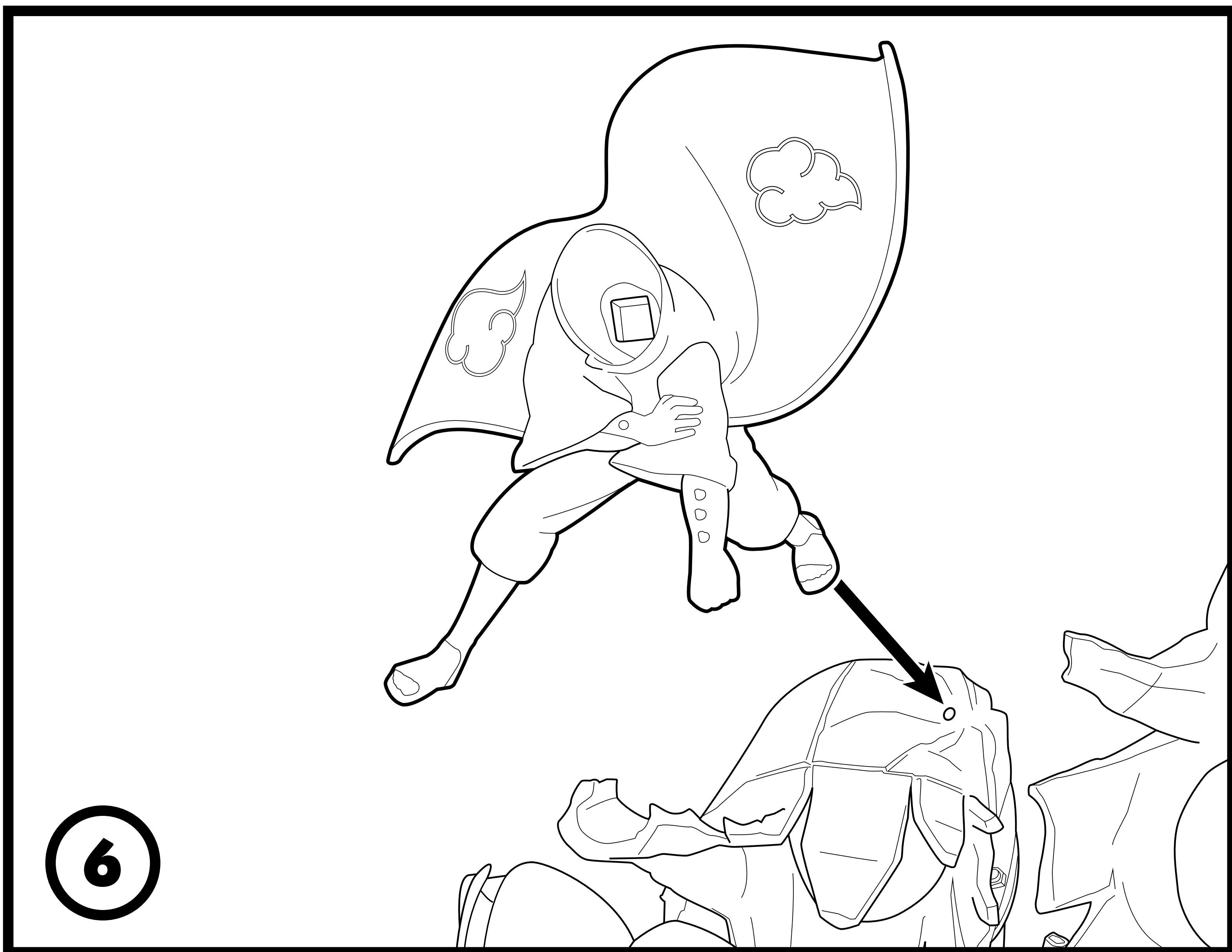

**6** Placez le second Pain en haut du premier tuyau.  
Place the second Pain on top of the first pipe.

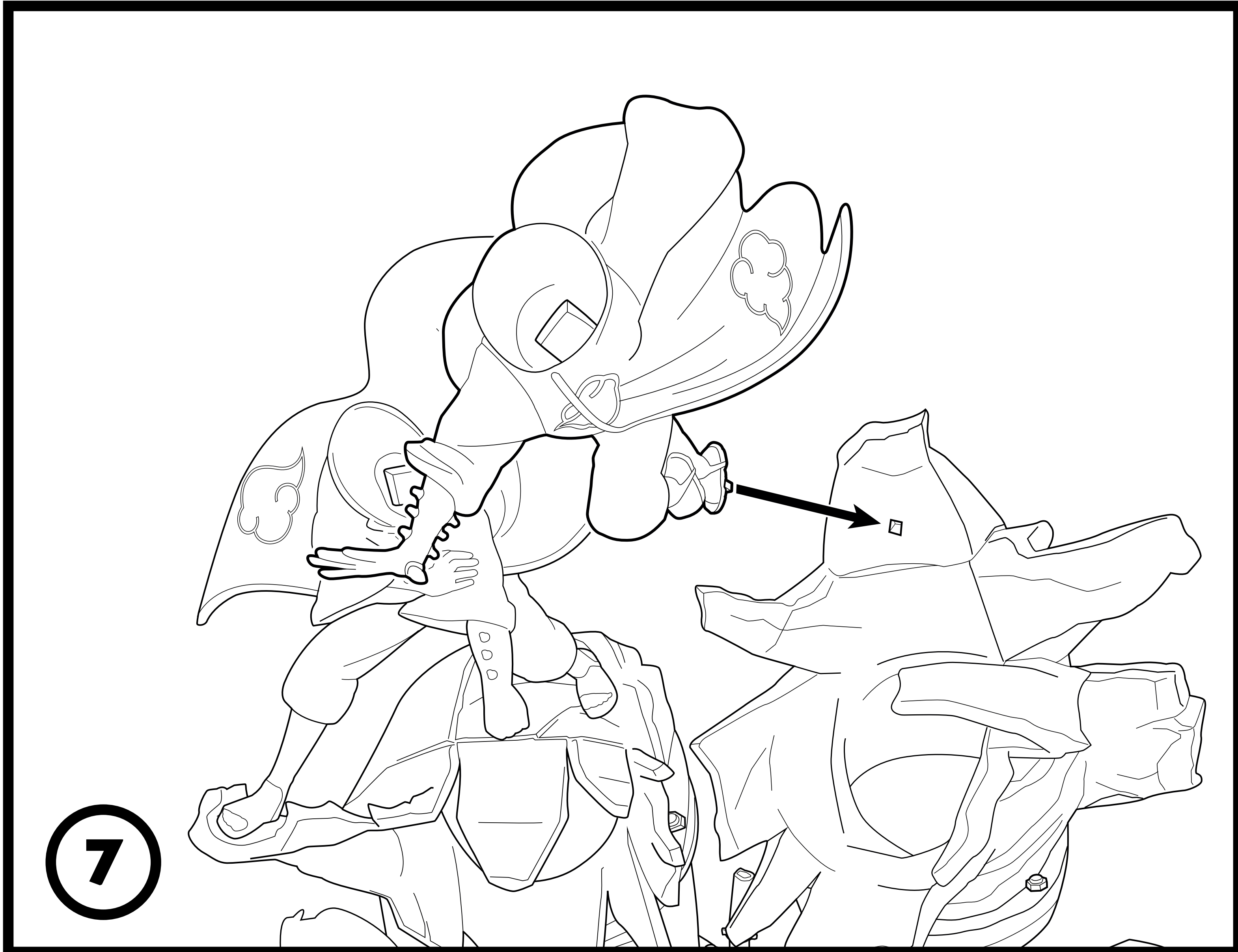

- 7** Insérez le troisième Pain au sommet du second tuyau.  
Insert the third Pain into the top of the second pipe.

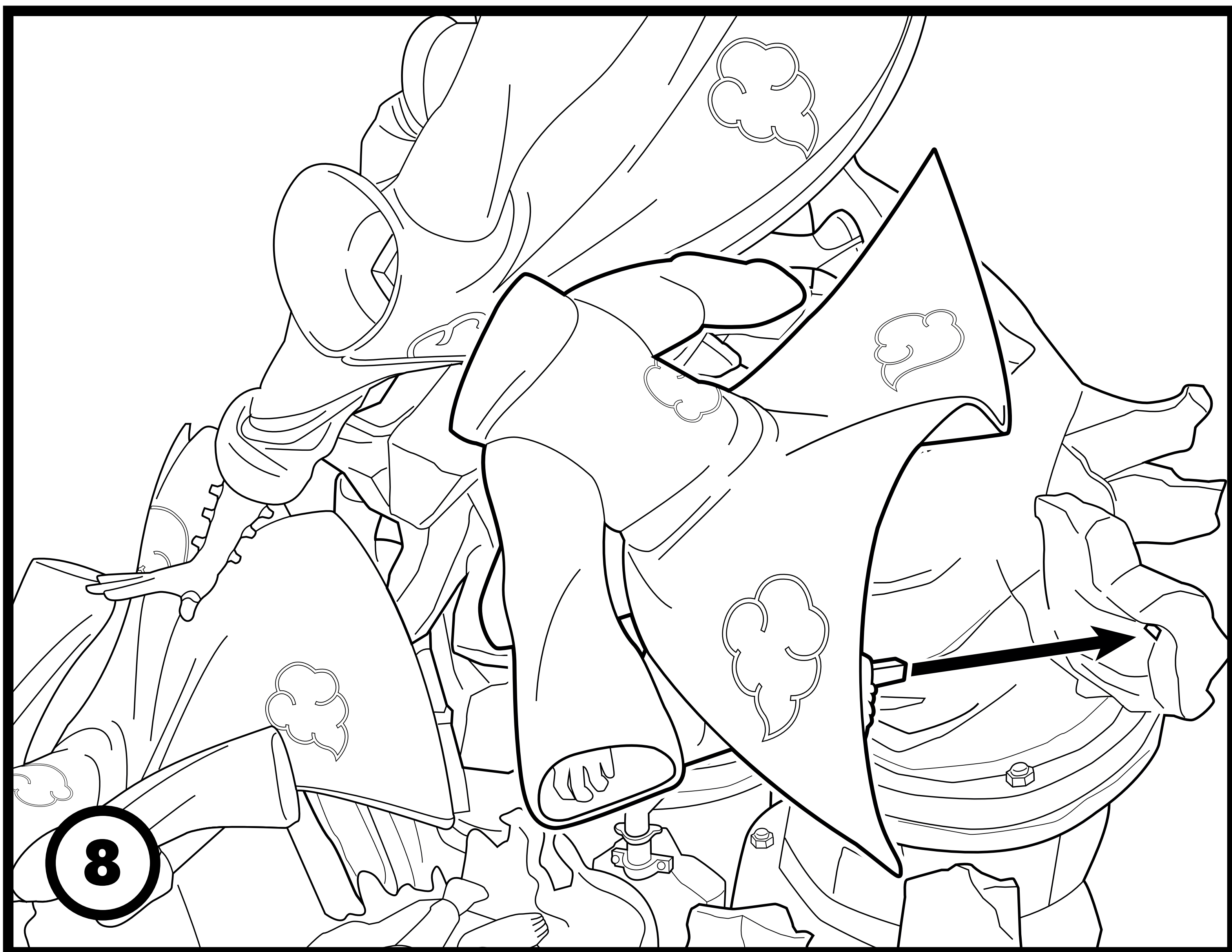

- 8** Placez le quatrième Pain sur le côté du second tuyau.  
Place the fourth Pain on the side of the second pipe.

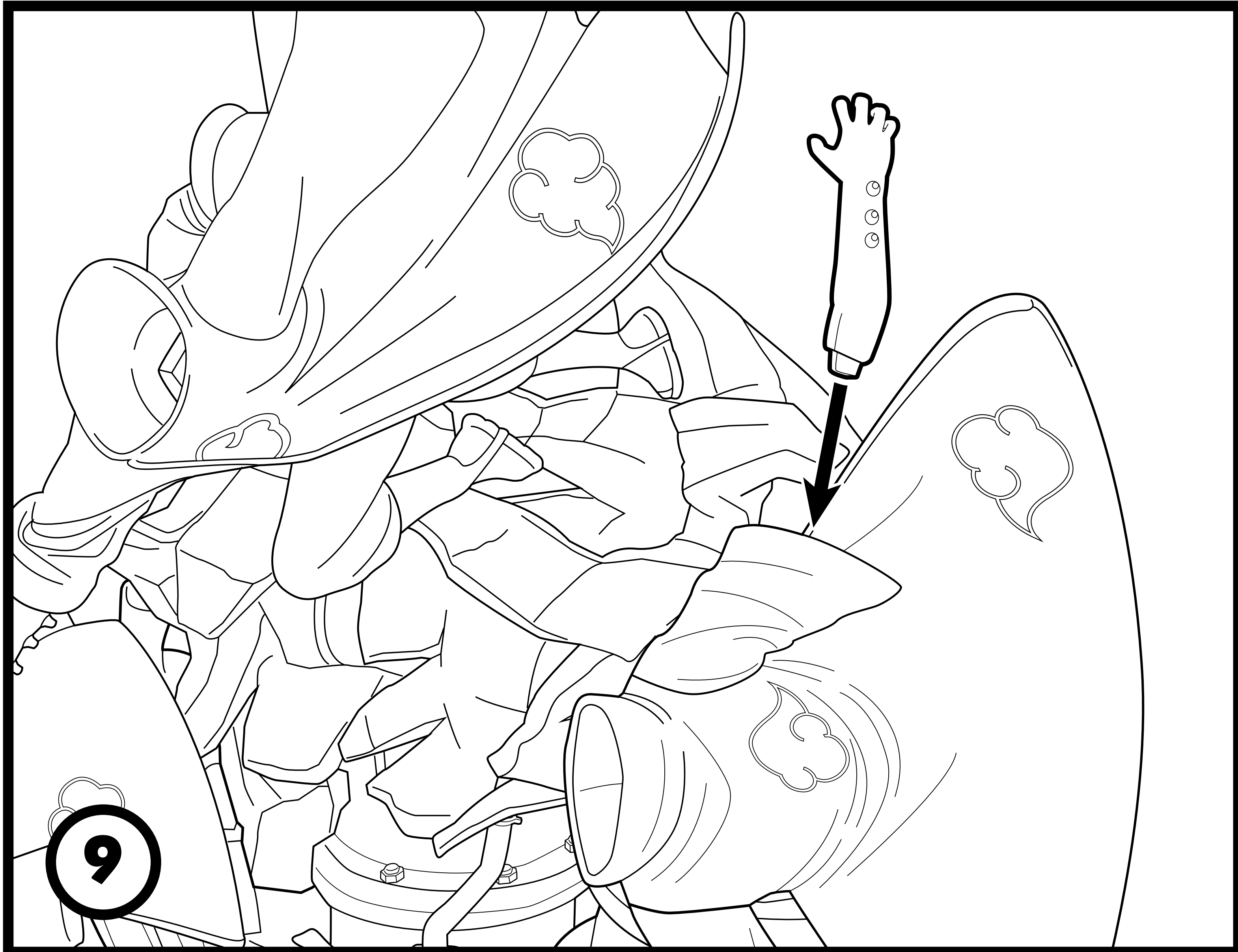

**9** Insérez le bras du quatrième Pain dans sa manche.  
Insert the forth Pain's arm into his sleeve.

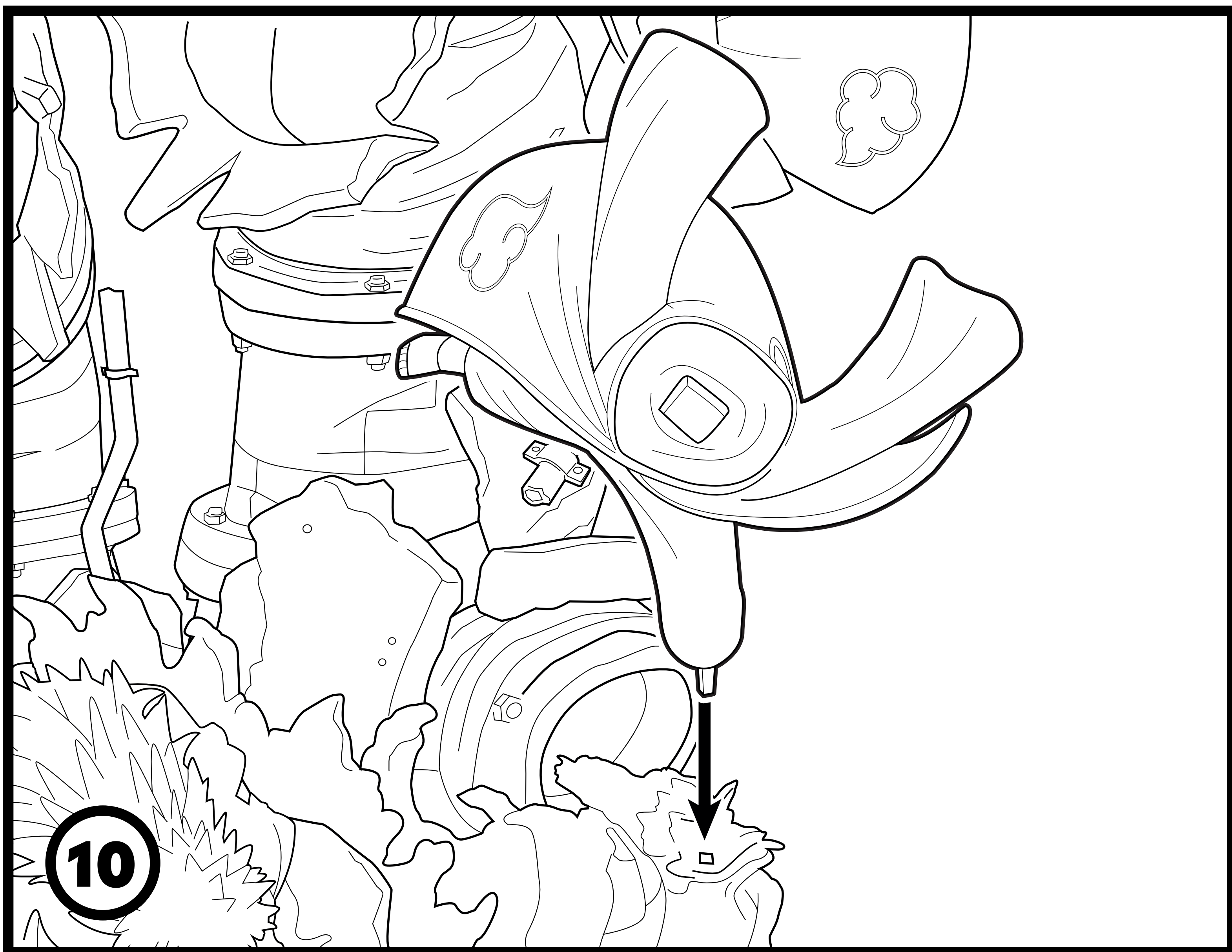

**10** Insérez le genou du cinquième Pain dans la vague à droite du socle.  
Insert the fifth Pain's knee into the wave on the right.

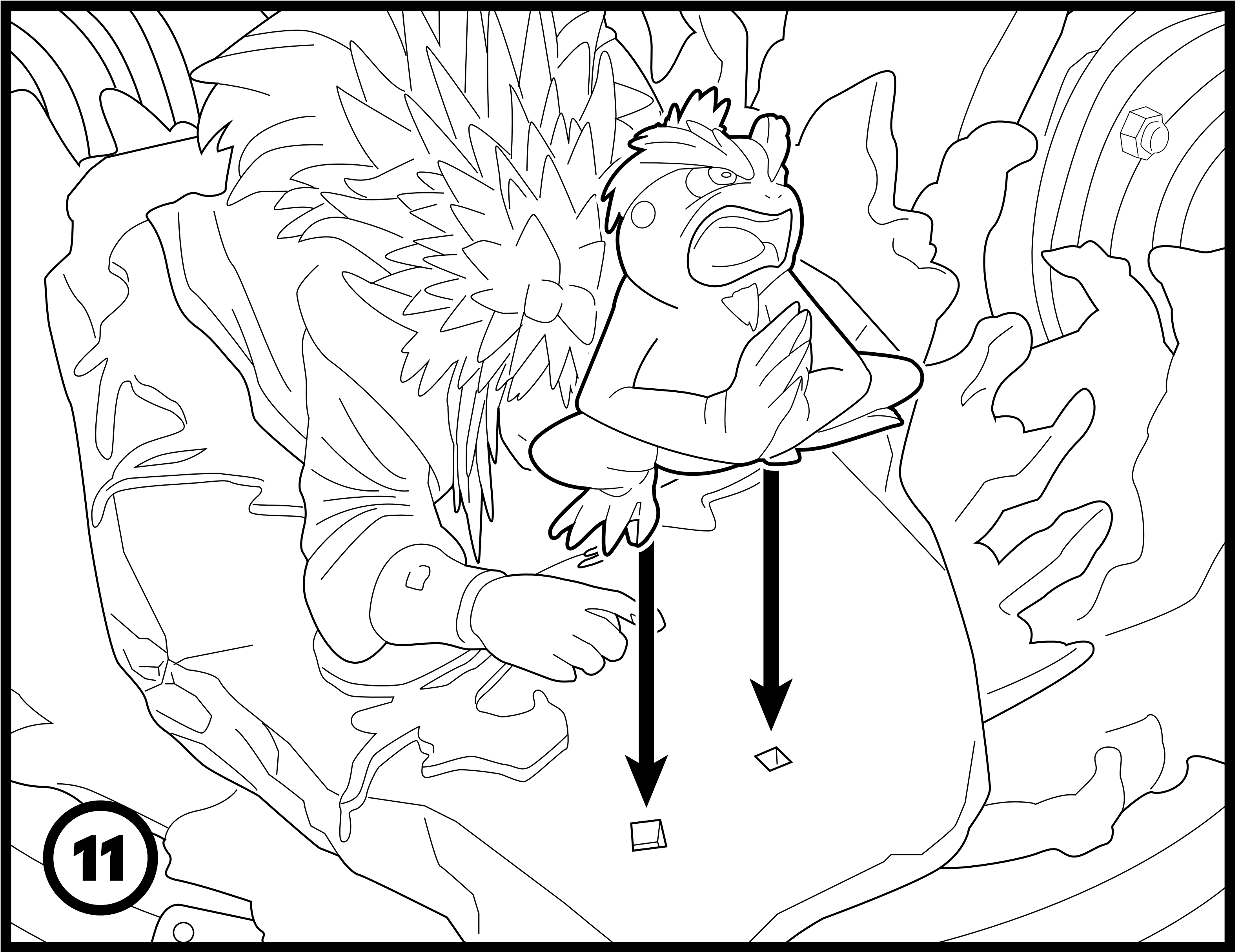

**11** Insérez le crapaud dans le socle, devant Jiraiya.  
Insert the toad into the base, in front of Jiraiya.



**12** Insérez les têtes des 5 Pain.  
Insert the heads of the 5 Pain.



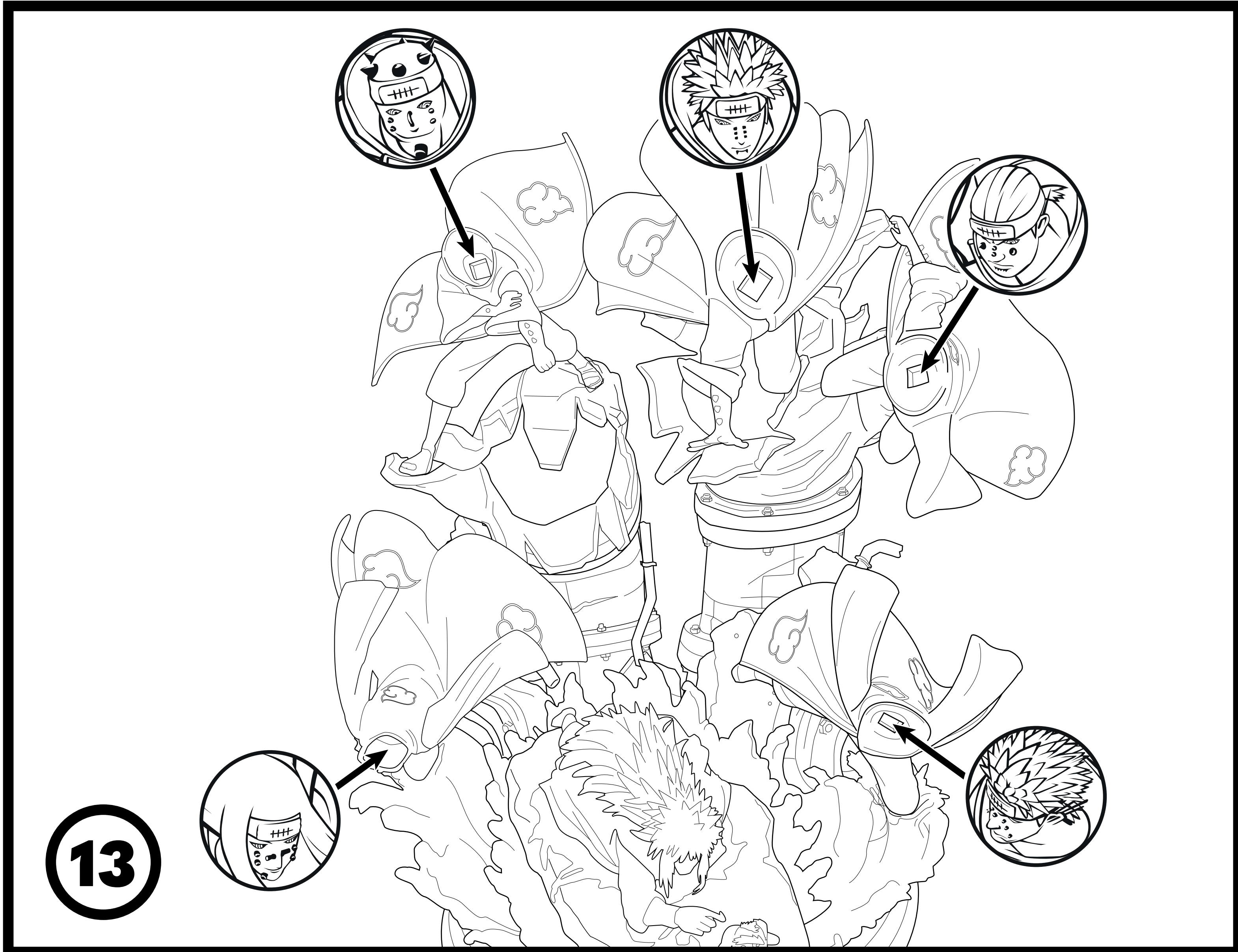

**13** Le placement des têtes pour les 5 Pain.  
The placement for the 5 Pain's heads.

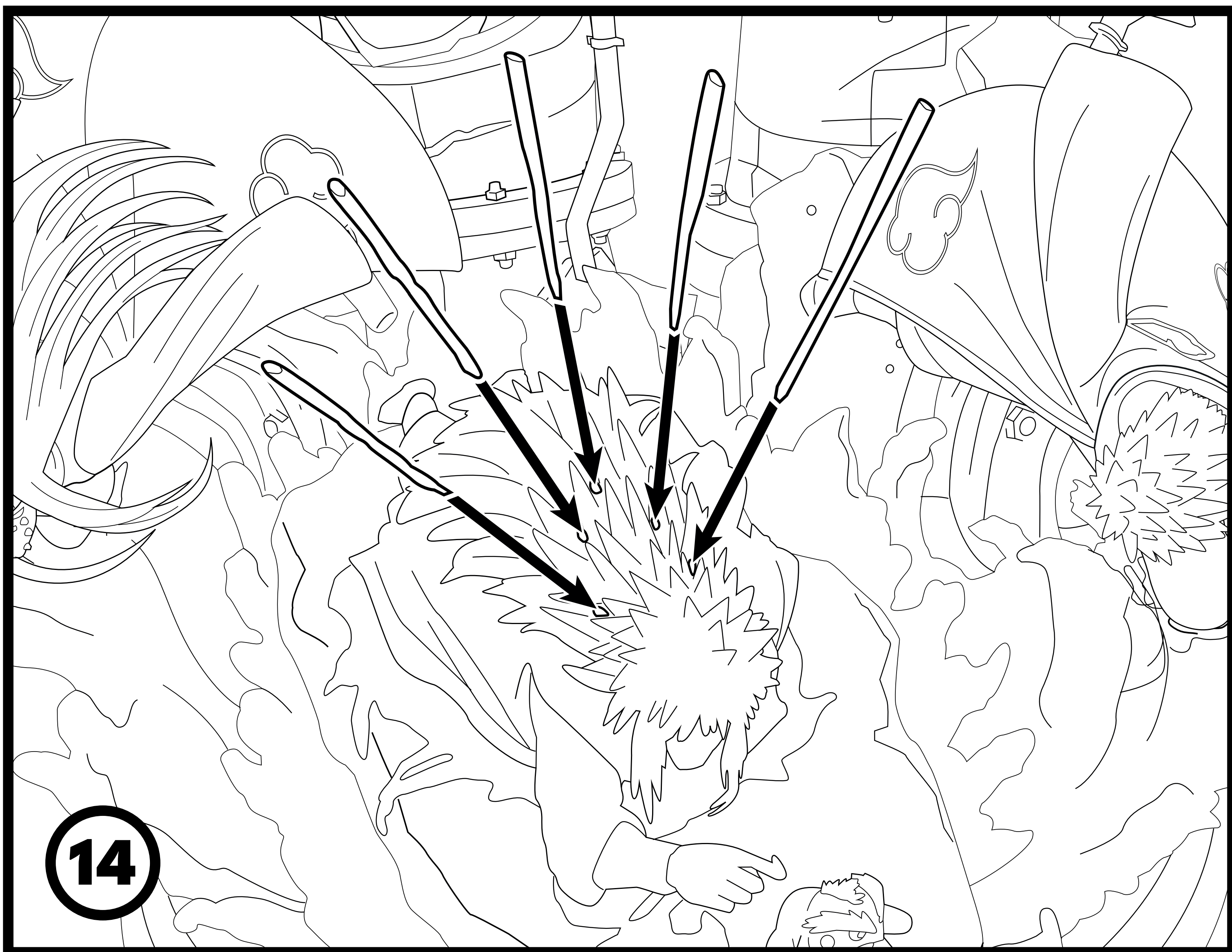

**14** Insérez les 5 bâtons dans le dos de Jiraiya.  
Insert the 5 rods into Jiraiya's back.

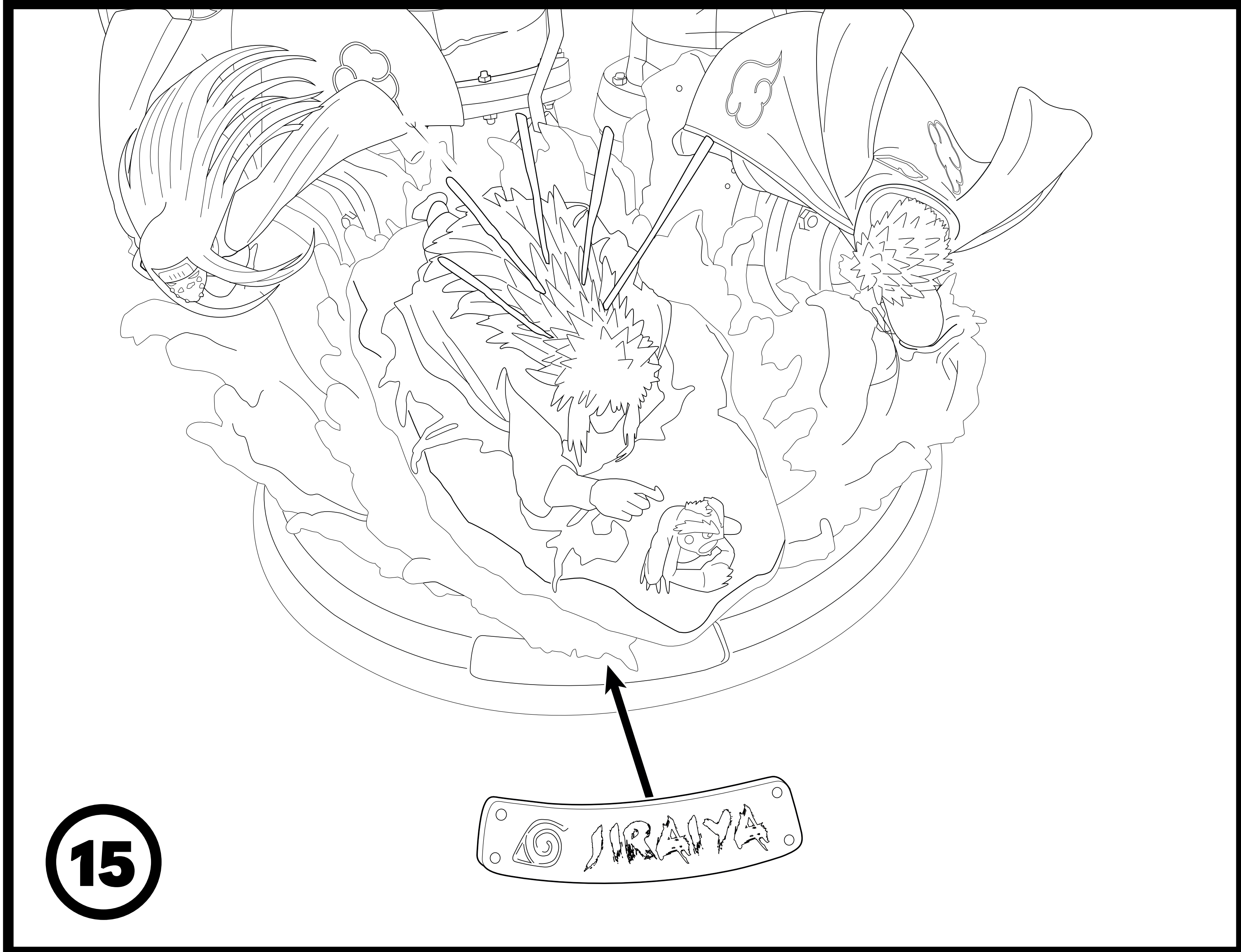

- 15** Placez le logo à l'avant du socle.  
Place the logo at the front of the base.